



Gerald Desmond Bridge Replacement Project

Caltrans • Metro • Port of Long Beach • US Department of Transportation

Short-term Detour

55-Hour Closure on Ocean Blvd. between Pico Ave. and SR-47

Date: January 24, 2020

Duration: Short Term

CLOSURE: Beginning 10 p.m. on Friday, January 24, there will be a 55-hour closure of Ocean Boulevard between Pico Avenue and SR-47 to shift both the eastbound and westbound lanes about 100 feet (30 meters) to the north. This closure will accommodate future grading and roadway construction along Ocean Boulevard on Terminal Island.

The result of this traffic pattern change will be the creation of a curved roadway that will gradually ascend just after the SR-47 off-ramp for motorists headed west toward San Pedro. For motorists headed east toward Long Beach, there will be a short descending curve after crossing the SR-47 overpass. As a safety measure to reduce speeds through the area, eastbound lanes will narrow to one lane through the curve, then re-open to three lanes before reaching the Gerald Desmond Bridge. Access to Pier T will be maintained at all times.

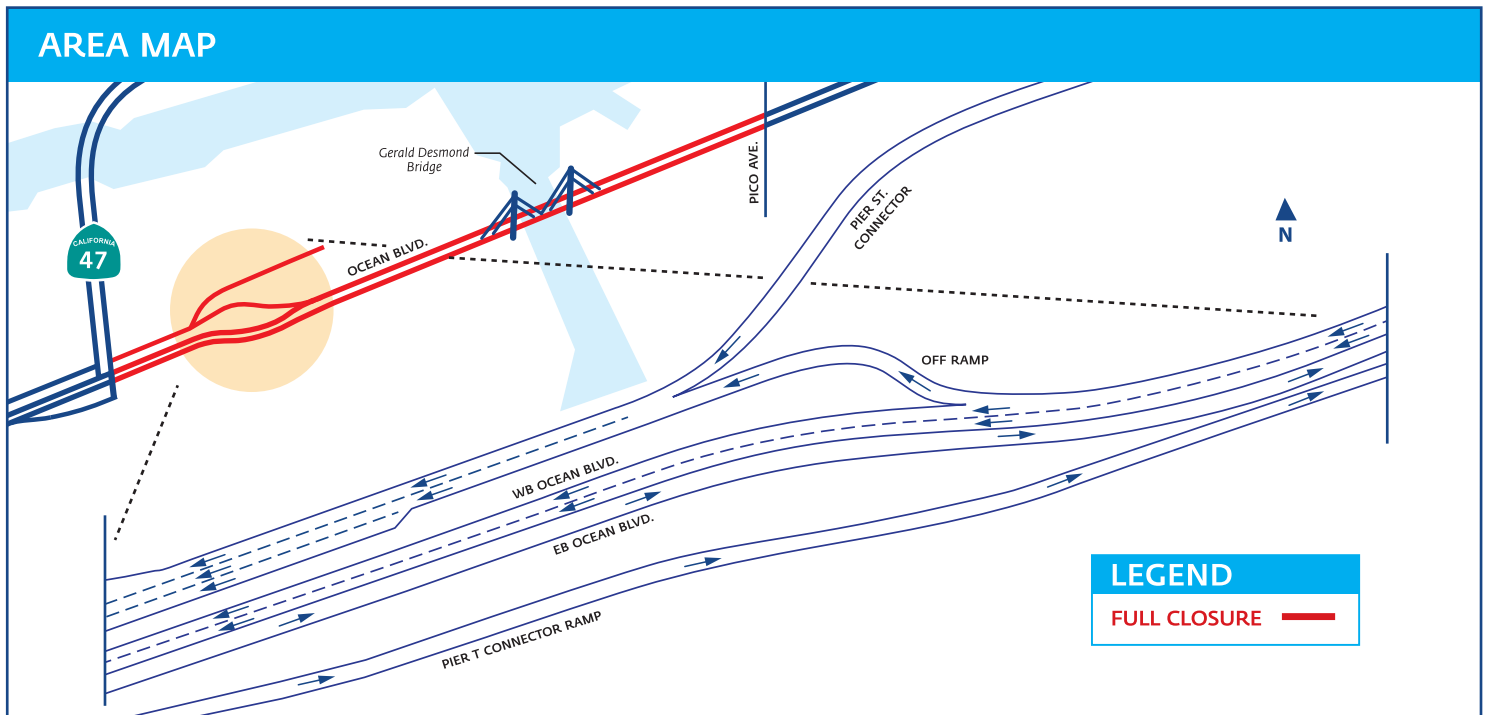

CONTACT US:

Daniel Rhodes
Community Liaison
(562) 485-2780
Daniel.Rhodes@GDBRProject.com

Lee Peterson
Communications & Community Relations
(562) 283-7715
Lee.Peterson@polb.com

STAY CONNECTED:

newgdbridge.com
 @newgdbridge
 LBBridgeProject

(562) 485-2780
 info@GDBRproject.com
 LB Bridge (App)